

Philippe

by Philippe Chow

DOWNTOWN

355 W 16th Street, New York, NY 10011
(Between 8th & 9th Aves)
Inside Dream Hotel
philippechow.com

Party Rooms

OUTDOORS

The Pagoda House
Seats 25 Guests

INDOORS

One Floor, Two Rooms
Seats 20 to 176 Guests

PHOTOS

See Next Page

PHILIPPE CHOW DOWNTOWN

355 W 16th Street, New York, NY 10011
(Between 8th & 9th Aves) Inside Dream Hotel

Philippe
by Philippe Chow

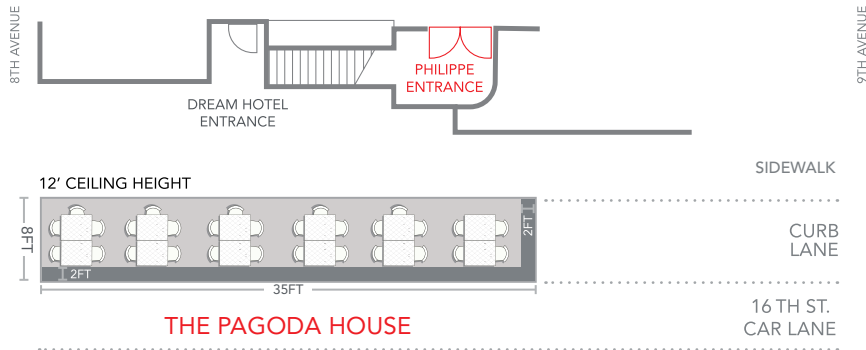

Outdoor Dining

Buyout 29 Guests. Street Level. 1 Room

| | Seat | Stand |
|--------------|------|-------|
| Pagoda House | 25 | 20 |

Features:
Ceiling Fans
Sliding Doors
Overhead Heaters
Surround Sound
Track Lighting



THE PAGODA HOUSE: INTERIOR

Guests enter the "pagoda" through tinted sliding glass doors. Each table has its own window allowing for an open airy al fresco dining experience with coverage. The interior is outfitted with beautiful wood floors that showcase 4x4 dining tables, floral, votives and white tablecloths. The vaulted ceilings are illuminated with track lighting, luxe chandeliers, ceiling fans, heat lamps and a surround sound audio system. Guests are protected from all inclement weather conditions.



THE PAGODA HOUSE: EXTERIOR

Philippe Downtown's outdoor dining "pagoda" house offers an authentic Philippe Chow fine dining experience for both public and private dining. The glamorous pearl and gold exterior sets the tone for a stylish event.



PHILIPPE CHOW. INDOOR DINING. TWO ENTRANCES

Philippe Chow indoor restaurant has two (2) street level entrances (including an elevator). The formal entrance to Philippe leads guests down a beautifully lit mirrored staircase. For those guests that prefer elevator service, they can enter through the Dream Hotel which is adjacent to the Philippe entrance.



PHILIPPE CHOW DOWNTOWN

355 W 16th Street, New York, NY 10011
(Between 8th & 9th Aves) Inside Dream Hotel

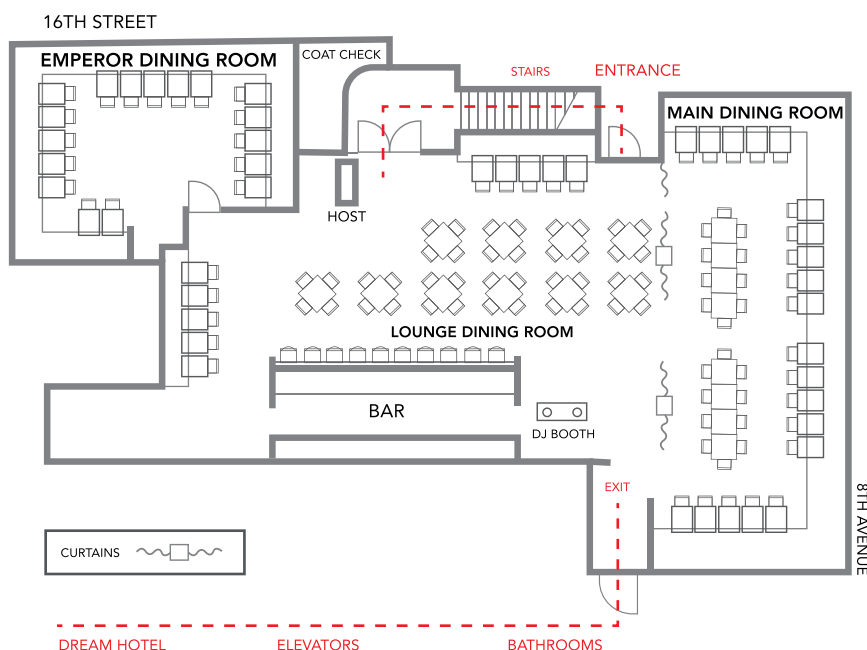

Indoor Dining

Buyout 176 Guests 3 Rooms. 1 Floor

| | Seat | Board | Stand |
|---------------------|------|-------|-------|
| Emperor Dining Room | 40 | 20 | 45 |
| Main Dining Room | 60 | 30 | 70 |
| Lounge Dining | 60 | x | 60 |
| Bar | 10 | | |



THE BAR

Upon arrival, guests are lured down a mirrored staircase lit by delicate gold fixtures and welcomed by the glamorous full service golden back-lit bar.



THE LOUNGE DINING ROOM & DJ BOOTH

Electricity flows in this highly designed dining room which sets the stage as guests begin their evening. The DJ Booth commands attention with its glamorous mirrored exterior.



THE MAIN DINING ROOM

Open and flexible, the main dining room features adjustable spaces ideal for a variety of private and semi-private gatherings. Retractable floor length curtains provide privacy from the Lounge Dining room. Seating options vary from luxurious crocodile embossed banquets to free standing tables.



THE EMPEROR DINING ROOM

Guests are welcomed into this exclusive, private dining room by sultry gilded chandeliers suspended from a gold leafed ceiling surrounded by refined textured gold leaf walls. Seating options vary from luxurious crocodile embossed banquets to free standing tables. The room also includes technical capabilities such as an Apple TV and full control over sound and lighting.